

STAINLESS STEEL 304 PRESS FIT FITTINGS (M PROFILE)

COMPLY WITH BSEN1254-2: 1998

MI SOCKET



A Product of the nPressGuard® Solution

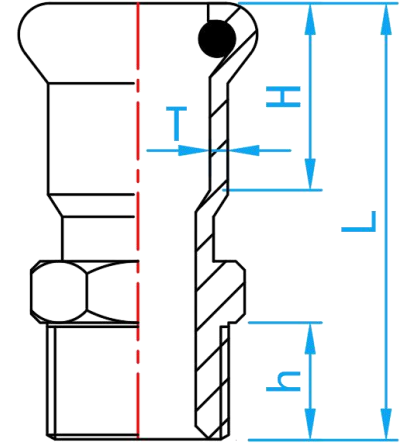

CROSS SECTIONAL VIEW

DIMENSIONS

SKU	SIZE (mm x inch)	L (mm)	H (mm)	h (mm)	T (mm)	WEIGHT (kg)	PCS/CTN
SSPFNMAI01515	15 × 1/2" BSPT	51.0	20	15	1.5	0.044	420
SSPFNMAI02015	22 × 1/2" BSPT	53.0	20	15	1.5	0.060	170
SSPFNMAI02020	22 × 3/4" BSPT	55.0	21	16	1.5	0.065	200
SSPFNMAI02025	22 × 1" BSPT	70.0	24	16	1.5	0.105	130
SSPFNMAI02515	28 × 1/2" BSPT	66.5	24	14	1.5	0.075	130
SSPFNMAI02520	28 × 3/4" BSPT	58.0	24	16	1.5	0.082	130
SSPFNMAI02525	28 × 1" BSPT	62.0	33	19	1.5	0.105	130
SSPFNMAI03515	35 × 1/2" BSPT	76.0	26	15	1.5	0.095	80
SSPFNMAI03520	35 × 3/4" BSPT	75.0	26	15	1.5	0.100	80
SSPFNMAI03525	35 × 1" BSPT	67.0	26	21	1.5	0.120	80
SSPFNMAI03535	35 × 1 1/4" BSPT	70.0	26	21	1.5	0.160	80
SSPFNMAI03542	35 × 1 1/2" BSPT	82.0	28	22	1.5	0.165	66
SSPFNMAI03550	35 × 2" BSPT	92.0	26	26	1.5	0.300	38
SSPFNMAI04215	42 × 1/2" BSPT	81.0	31	14	1.5	0.120	50
SSPFNMAI04220	42 × 3/4" BSPT	82.0	31	16	1.5	0.132	50
SSPFNMAI04225	42 × 1" BSPT	84.0	24	22	1.5	0.150	50
SSPFNMAI04235	42 × 1 1/4" BSPT	75.0	31	21	1.5	0.180	50
SSPFNMAI04242	42 × 1 1/2" BSPT	75.0	31	21	1.5	0.195	66
SSPFNMAI04250	42 × 2" BSPT	96.0	31	21	1.5	0.320	50
SSPFNMAI05020	54 × 3/4" BSPT	94.0	35	16	1.5	0.178	60
SSPFNMAI05025	54 × 1" BSPT	95.0	35	19	1.5	0.198	50
SSPFNMAI05035	54 × 1 1/4" BSPT	96.0	35	20	1.5	0.232	38
SSPFNMAI05042	54 × 1 1/2" BSPT	95.0	35	21	1.5	0.246	38
SSPFNMAI05050	54 × 2" BSPT	88.0	36	26	1.5	0.320	38
SSPFNMAI06565	67 × 2 1/2" BSPT	110.0	50	30	1.8	0.735	15
SSPFNMAI08065	76 × 2 1/2" BSPT	115.0	55	30	2.0	0.626	24
SSPFNMAI08080	76 × 3" BSPT	117.0	55	32	2.0	0.825	24
SSPFNMAI100100	108 × 4" BSPT	148.0	80	35	2.0	1.243	10